

EG SERIES
CNC External
Cylindrical Grinders

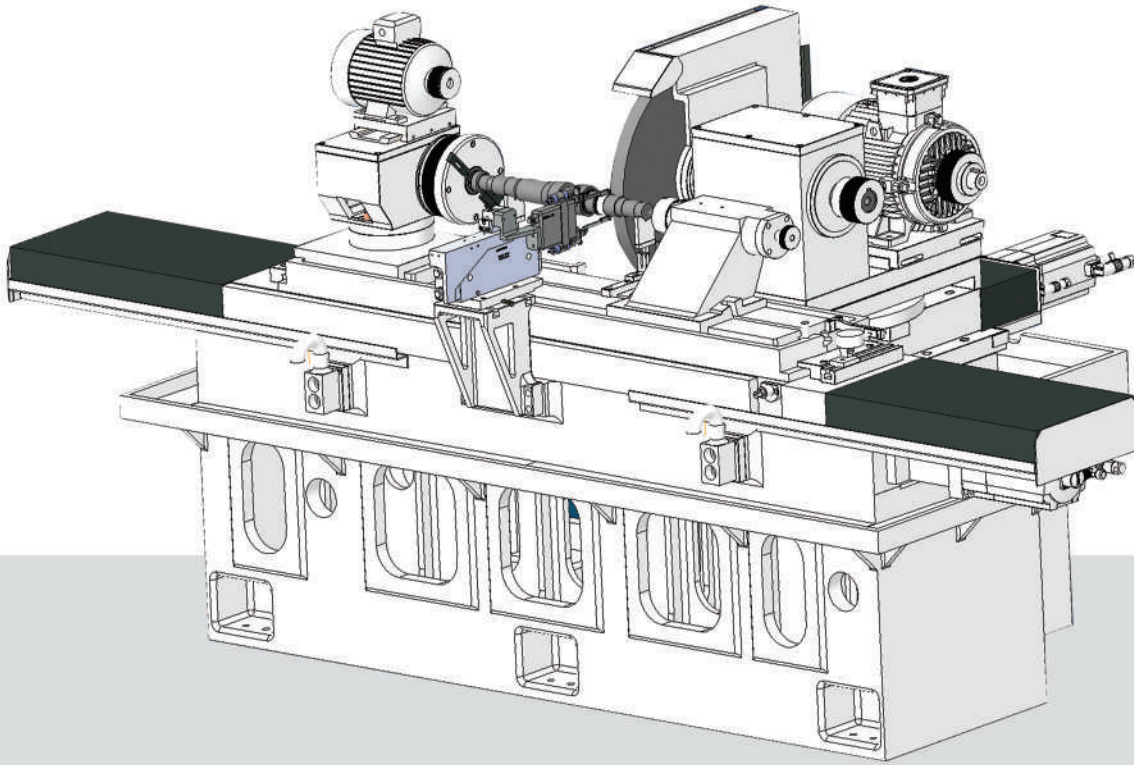

OVERVIEW



MACHINE BED

The Machine bed is made of one piece close special graded grain cast iron box structure design with optimum ribbing provides high static and vibration free dynamic rigidity to the machine. Artificial Stress relieving process carried for more dimensional stability.

Precision hand scraped V-Flat table guide ways for Z-axis and Cross Roller slide for X-axis with centralised lubrication.

Laser calibrated axis for high precise positioning Accuracy and Repeatability.

EG SERIES

CNC External Cylindrical Grinders



WHEEL HEAD

Machine is provided with Cartridge type Wheel spindle with two match pair sets of Angular Bearing for smooth performance while material cutting. Spindle is driven by induction motor and transmitted by Poly V belt.

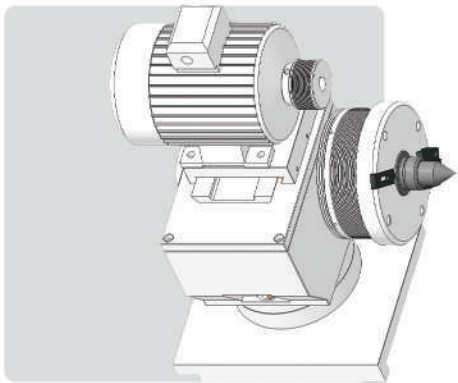
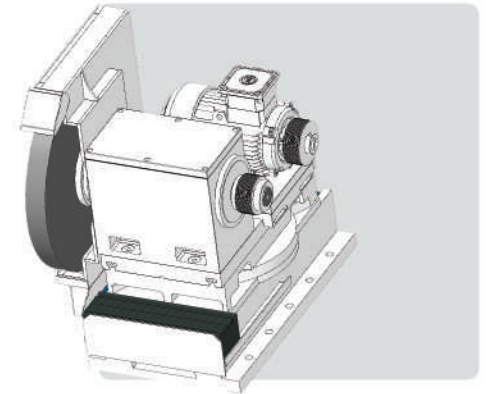

WORK HEAD

Work head spindle is made of case hardened alloy steel and runs with precision Taper Roller and Ball Bearing for Live and Stationery center. The drive to the work head is by induction motor via VFD to control job rpm for Grinding. The work head can be swivelled for taper grinding by chuck clamping/holding.

TAIL STOCK

The tail stock is spring loaded and can accept MT-4/5 taper and work as dead center as per models mentioned in specification.

Dresser unit able to mount on Tail Stock unit of production line.

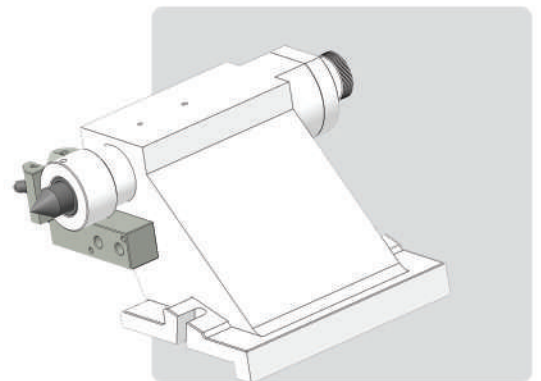

COOLANT

Generous coolant supply is provided with electrical pump fitted on separate tank according to model. Different option available as additional accessory.

ENCLOSURE

Model EG-450 / 600 with Full enclosure. EG-800 / 1000 / 1200 with Half enclosure.

ELECTRICALS

The machine is supplied with all electrical suitable for 3Ø, 415 V Ac, 50 Hz cycle. The motors are approved & reputed brand make with IE2 standard. The electrical panel with A.C. is mounted on one side of the machine. Operating panel is located nearest to working area for easy reach of the operator.

STANDARD FEATURES

CONTROLLER SPECIFICATION & FEATURES

- Two Axis CNC External Grinder with Siemens 808D as standard. Dedicated Pro grams with Plunge, Travers Grinding and Dressing Cycles.
- G code / M code compatibility with other NC builders.
- Single Touch Point Logic for Multi Diameter.
- Total 17+1 Touch Point Feasibility.
- Individual Wear Correction Feasibility.
- Single Wear Correction for All Diameter Processing without IPG.
- Skip Dressing Cycles.
- Pitch error & Back Lash compensation.
- Electronic hand wheel.
- RS 232 C serial Interface port.
- Inch/Metric switchable.
- Auto Programmable Centralise Lubrication Unit.
- AC Servo axis for Drive.

OPTIONAL ACCESSORIES

- Siemens 828 Advance, Fanuc OiTF Controller.
- Servo Controlled C axis (Work Head).
- Linear Glass Scale (for single or both axis). **
- Magnetic Separator.
- Paper band with Magnetic Coolant Separator.
- Roll Dressing attachment with Spindle (without Diamond Roll).
- Pedal Operated Chuck with heavy work head for live center only.
- Pedal Operated Hydraulic Tailstock.
- Servo motor for work head 6 Nm.
- 7.5 hp Induction motor for Wheel head (EG 450 / 600 model)
- VFD for Wheel head with potentiometer
- To maintain CSS, VFD required for Wheel head and Work Head with Servo as 3rd Axis in lieu of standard.
- 4th axis for Servo controlled Radius Dresser.
- Single Dia. In-Process Gauge.
- Multi Dia. In-process Gauge.
- Flanging unit.
- Auto loading-unloading system (Based on component Structure).
- Dynamic wheel balancer.
- Gap N Crash Unit.
- 20 KVa Servo Voltage Stabilizer.

** For Glass Scale Siemens 828D / Fanuc OiTF controller is mandatory.

SPECIFICATION

DESCRIPTION	UNIT	MODEL				
		EG 450	EG 600	EG 800	EG 1000	EG-1200
CAPACITY						
SWING OVER TABLE	mm	300	300	350	350	350
ADMIT BETWEEN CENTRES	mm	450	600	800	1000	1200
WORK HEAD CENTER HEIGHT*	mm	150 (200 OPTIONAL)		175 (200 OPTIONAL)		
GRINDING DIAMETER MAX (O.D.)	mm	300	300	350	350	350
GRINDING DIAMETER MIN (O.D.)	mm	5		25		
MAX. WEIGHT OF JOB BETWEEN CENTER	kg	70		120		
WHEEL HEAD						
GRINDING WHEEL SIZE (OD X ID X WIDTH)	mm	500X127X40				
WHEEL DISCARD DIAMETER	mm	250				
SPINDLE DIMENSION	mm	Ø150 X 355				
SPINDLE SIZE	mm	Ø70				
SPINDLE SPEED@	rpm	1600/3500 (33~45 MPS)				
SPINDLE MOTOR POWER	kw/hp	3.7/5 (5.5/7.5 OPTIONAL)		5.5/7.5		
MIN. INCREMENT ON DIAMETER	mm	0.001				
WORK HEAD						
TAPER BORE**	mm	MT-4 (MT-3 OPTIONAL)		MT-5 (MT-4 OPTIONAL)		
SPINDLE SPEED	rpm	30-500				
SPINDLE MOTOR POWER	kw/hp	0.75/1				
SWIVEL OF WORK HEAD	deg(°)	±45°				
CROSS TABLE (X-AXIS)						
X-AXIS STROKE	mm	200		300		
RAPID FEED RATE	mtr/min	15				
MINIMUM RESOLUTION	mm	0.001				
SERVO MOTOR TORQUE	Nm	8				
BALL SCREW	mm	Ø32 X 5				
GUIDE WAYS TYPE	mm	CROSS ROLLER 12 X 12ROLLER SIZE				

SPECIFICATION

DESCRIPTION	UNIT	MODEL				
		EG 450	EG 600	EG 800	EG 1000	EG-1200
LONGITUDINAL TABLE (Z-AXIS)						
TABLE STROKE	mm	480	630	830	1030	1230
MAX. SWIVEL OF TABLE	deg(°)	7°				
Z-AXIS STROKE	mm	550	650	900	1100	1300
RAPID FEED RATE	mtr/min	15				
MINIMUM RESOLUTION	mm	0.001				
SERVO MOTOR TORQUE	Nm	8				
BALL SCREW	mm	Ø32 X 10		Ø40 X 10		
GUIDE WAYS TYPE	-	V AND FLAT TURCITE				
TAILSTOCK						
CENTER TAPER#	mm	MT-4 (MT-3 OPTIONAL)		MT-5 (MT-4 OPTIONAL)		
QUILL TRAVEL	mm	20		25		
QUILL DIA.	mm	Ø 45		Ø 60		
HYDRAULIC UNIT						
TANK CAPACITY	litre	50		100		
MOTOR POWER	kw/hp	0.37/0.5				
PUMP CAPACITY	lpm	4				
GENERAL						
OPERATION VOLTAGE	volts	415V,3PH,AC 50HZ				
TOTAL POWER REQUIRED	kw/hp	12/16				
FLOOR SPACE	mm	2750 X 2000 (FULL ENC LOSER)	3020 X 2000 (FULL ENC LOSER)	3500 X 2500 (HALF ENC LOSER)	3950 X 2290	4500 X 2500 (HALF ENC LOSER)
MACHINE WEIGHT(APPROX.)	kg	3350	3600	4411	4840	4950

Note:
 Minimum and Maximum grinding diameter as specified above may vary based on specific requirement. Work head spindle is with Live and Dead center operating provision. Features and Specification may vary as specific job requirement. Colour as shown in picture may not match with actual machine colour. Machine Guard May Change as per Job Specification and Accessary used. Admit between center, Grinding length, Wheel utilisation will change depending upon swivel angle. Please discuss suitability to your requirement before ordering to us. As a part of Continuous Improvement Process, design and specification subjected to change without prior notice and information.

ignite

kiyaproducts.com

KIYA PRODUCTS PRIVATE LIMITED

Plot No. G-1925, Gate-2 (Almighty Gate), Kalawad Road,
Lodhika GIDC, Vill-Matoda, Dist-Rajkot-360021 Gujarat (India).

M +91 93281 61506

E sales@kiyaproducts.com